

STREET INDEX	
ADRIAN DRIVE	D-8
ANTRIE CHASE	F-3-4
AMHERST DRIVE	E-7-8
ANDREW ROAD	C-1-3
ARLINGTON CHASE	C-3-4
ASCOTT CHASE	F-3-4
AUTUMN RIDGE COURT	B-5
BACK BAY DRIVE	G-10-11
BAYLOR DRIVE	D-8
BELMONT CHASE	F-3-4
BIRCH LAKE DRIVE	H-1-8
BLUE SPRINGS DRIVE	G-10
BRIDGEPORT DRIVE	D-7
BRITTON PLACE	I-2
BROOKSIDE GLEN DRIVE	G-7-8
CABIN SHED TRAIL	A-5-1-4
CHARTER OAK DRIVE	D-4
CHIMNEY VIEW LANE	A-3
CHIMNEY ROCK COURT	C-6
CONKLE COURT	G-6
CROSSING DRIVE	F-8
CROWN POINT DRIVE	E-7-9
DOGWOOD COURT	C-4
DUNBAR DRIVE	D-7
EMORY DRIVE	E-8
EVERGREEN WALK	C-5-6
FELLSIDE LANE	G-5
FIRST STREET	F-6-5-9
FLAGLAND DRIVE	D-7-8
FLEETWOOD DRIVE	G-10-11
FOUNTAIN PARK DRIVE	C-5-6
GALAXIE DRIVE	F-10
GEORGETOWNE ROAD	E-3-6
GOLF CREST COURT	A-4-5
GODDENSEN TRAIL	F-6
GREEN MEADOW DRIVE	C-6
GRIDGE COURT	F-6
HANNAH DRIVE	I-3
HARTFORD DRIVE	E-8
HARVEST COURT	C-4
HAYTHORNE CHASE	F-4
HICKORY RIDGE LANE	A-3-4
HILL TOP DRIVE	I-7
ILLINOIS BOULEVARD	G-9-10
ISLA DRIVE	F-9
KINGSPONT DRIVE	E-9-10
KINGSTON DRIVE	F-8
LAKEVIEW DRIVE	G-7-8
LANDSHIRE DRIVE	E-9
LIGHTSTONE COURT	C-6
LOST TREE DRIVE	G-5-7
MAIN STREET	C-8
MALLARD WAY	F-8
MARSHIE COURT	B-3
MEADOWLANDS DRIVE	G-7
MIDDLEBURY DRIVE	E-8-9
MIDLOCK LANE	B-5
NINE ROCK ROAD	C-5-8
NINO DRIVE	H-1-8
NORTH STREET	C-9-10
OLD TIPTON SCHOOL ROAD	D-5-9
OPAL LANE	G-10
PARKWAY DRIVE	G-6
PARKWAY DRIVE	D-7-7-9
PARTHOSSE PASS	F-8
PHEASANT RUN	E-7-5-7
PIMLICO CHASE	G-4
PINE DRIVE	H-9
PONDER WAY	E-7-9
PORTLAND DRIVE	D-8
POSSUM PASS COURT	C-6
PRAIRIE LAKE DRIVE	I-1-12
PRAIRIE PLACE	C-6
PRINCE DRIVE	F-8
PRIVATE ROAD	E-6
QUAL ROOST COURT	F-7
QUEENSKY DRIVE	F-8
RADFORD DRIVE	E-7-8
RAIL FENCE DRIVE	D-3-4
RAMBLEWOOD LANE	F-6-7
RED BUD RUN	D-4
ROOSEVELT DRIVE	I-7
RUTGERS DRIVE	E-8
SARASOTA CHASE	F-6-5
SEBING ROAD	A-5
SECOND STREET	G-8
ROYAL DRIVE	F-8-9
SHERMAN BOULEVARD	G-10-12
SOUTH STREET	G-8
SPLIT RAIL DRIVE	D-3
STARBUCK DRIVE	D-6-7
STONEHILL DRIVE	D-1-8
ST. JAMES DRIVE	D-7
SUNSHINE DRIVE	I-3
THIRD STREET	C-8
THROUGH COURT	F-5
TIMBER EDGE DRIVE	G-6-7
TIMBERCREST DRIVE	H-7
TIMBERLINE LANE	I-2
TURTLE DOVE DRIVE	F-6
TRENTON DRIVE	E-10
VANDERBILT DRIVE	D-7
VILLA PARKWAY	E-6-7
VILLAGE CENTER DRIVE	G-10-12
WESTHAMPTON DRIVE	D-8
WILLIAMSBURG ROAD	E-5-6
WILLOW HILL DRIVE	H-8
WILLOW HILL COURT	G-10
WILLOW LANE	C-7
WINDMERE DRIVE	E-10
WINGATE DRIVE	E-7
WOOD DOCK COURT	F-6
WOODBRIDGE DRIVE	C-7
WOODS MILL ROAD	H-7
WORTHINGTON CHASE	F-4
XAVIER DRIVE	D-8-9
ZIMMERMAN DRIVE	H-5-8

SUBDIVISION INDEX	
BIRCH LAKES ESTATES	H-7-9
BIRCH LAKE DRIVE	F-10
CHARTER OAK DRIVE	H-1
HILL TOP DRIVE	I-7
PINE DRIVE	I-3
RIDGEVIEW	I-3
TIMBERCREST DRIVE	I-3
BRIERWOOD	H-1-8-9
FINE DRIVE	F-10
BRITTON PLACE NORTH	I-1-13
GRACE LANE	I-1-13
HANNAH DRIVE	F-8
BRITTON PLACE SOUTH	I-2-13
BRITTON PLACE	I-2-13
BROOKSIDE GLEN	G-7-8
BROOKSIDE GLEN DRIVE	G-7-8
LAKEVIEW DRIVE	G-7-8
LOST TREE DRIVE	G-5-7
MEADOWLANDS DRIVE	G-7
WILLOW LANE	C-7
CAROLINE ESTATES	D-7
THE CROSSING	F-7-8
CROWN POINT	E-7-9-10
CROWN POINT DRIVE	E-7-9-10
KINGSPONT DRIVE	E-9-10
LANDSHIRE DRIVE	E-9
PONDER WAY	E-7-9
WINDMERE DRIVE	E-10
FANCY CREEK ESTATES	A-7
WOODS MILL ROAD	H-7
FLAGLAND PARK	D-7-8-9
ADRIAN DRIVE	D-8
AMHERST DRIVE	E-7-8
BAYLOR DRIVE	D-8
BRIDGEPORT	D-7
DUNBAR DRIVE	D-7
EMORY DRIVE	E-8
FLAGLAND DRIVE	D-7-8
HARTFORD DRIVE	E-8
MIDDLEBURY DRIVE	E-8-9
PARKWAY DRIVE	G-6
PORTLAND DRIVE	D-8
RUTGERS DRIVE	E-8
SANT JAMES DRIVE	D-7
STONEHILL DRIVE	D-1-8
TRENTON DRIVE	E-10
VANDERBILT DRIVE	D-7
WESTHAMPTON DRIVE	D-8
WINGATE DRIVE	E-7
XAVIER DRIVE	D-8-9
GEORGETOWNE OAKS	D-1-6-8
GEORGETOWNE ROAD	E-3-6
WILLIAMSBURG ROAD	E-5-6
GOLDEN POND PLACE	H-5-7
PINE DRIVE	I-3
LYNNDALE	F-10
KINGWAY DRIVE	F-10
PRINCE DRIVE	F-8
QUEENSKY DRIVE	F-8
ROYAL DRIVE	F-8-9
NORTH HAVEN	D-6-7
STARBUCK DRIVE	D-6-7
OLD HICKORY AT THE RAIL	H-1-3
MARSHIE COURT	B-3
NINE ROCK LANE	B-5
OLD TIPTON ESTATES	C-5-6
CHIMNEY ROCK COURT	C-6
DOGWOOD COURT	C-4
EVERGREEN WALK	C-5-6
FOUNTAIN PARK DRIVE	C-5-6
LIGHTSTONE COURT	C-6
MAYFIELD CROSSING	C-6
NINE ROCK ROAD	C-5-8
RED BUD RUN	D-4
ORIGINAL SHERMAN	C-5-9
FIRST STREET	F-6-5-9
NORTH STREET	C-9-10
MAIN STREET	C-8
SECOND STREET	C-8
SOUTH STREET	C-8
THIRD STREET	C-8

SUBDIVISION INDEX	
PRARIE LAKE ESTATES	I-1-12
QUAIL POINT	F-7
QUAIL RIDGE	E-7-5-7
FIRST STREET	F-6-5-9
GOOSECREEK TRAIL	G-6-7
GRIDGE COURT	F-6
MERIDITH DRIVE	F-8
PARTHOSSE PASS	F-8
QUAL ROOST COURT	F-7
RAMBLEWOOD LANE	F-6-7
THROUGH COURT	F-5
TURTLE DOVE DRIVE	F-6
WOOD DOCK COURT	F-6
RAIL ESTATES	G-7-8
BROOKSIDE GLEN COURT	G-7-8
GOLF CREST COURT	A-4-5
RAIL MEADOWS	H-1-3
CABIN SHED TRAIL	A-5-1-4
CHIMNEY VIEW LANE	A-3
HICKORY RIDGE LANE	A-3-4
RAIL POINT	D-3-4
CEAR RAIL DRIVE	F-10
RAIL FENCE DRIVE	D-3-4
SPLIT RAIL DRIVE	D-3
RED BUD	D-4
RED BUD RUN	D-4
REDMARE ACRES	D-5
ROUTE 66 CROSSING	F-10-12
ILLINOIS BOULEVARD	G-9-10
GALAXIE DRIVE	F-10
VILLAGE CENTER DRIVE	G-10-12
SPRING LAKE ESTATES	H-1-3
NINO DRIVE	H-1-8
WILLOW HILL DR.	H-1-3
STEEPLECHASE	E-10-12
ANTRIE CHASE	F-3-4
ARLINGTON CHASE	C-3-4
ASCOTT CHASE	F-3-4
BELMONT CHASE	F-3-4
HAYTHORNE CHASE	F-4
PIMLICO CHASE	G-4
SARASOTA CHASE	F-6-5
WORTHINGTON CHASE	F-4
THE PRAIRIE AT BROOKSIDE GLEN	C-4-5-7
CORNHORN COURT	C-4
FIELDSTONE LANE	C-4
GREEN MEADOW DRIVE	C-6
HARROW DRIVE	C-4
HARVEST COURT	C-4
LOST TREE DRIVE	C-5-7
MERIDITH DRIVE	C-4
PARTHOSSE PASS	C-4
POSSUM PASS COURT	C-6
PRAIRIE PLACE	C-6
RAMBLEWOOD LANE	C-6-7
SUNSHINE DRIVE	I-3
TIMBER EDGE DRIVE	G-6-7
WOODBRIDGE DRIVE	C-7
THE RAIL	H-1-3
SEBING ROAD	A-5
TIMBERLINE ESTATES	I-2
TIMBERLINE LANE	I-2
VILLA EAST	H-1-3
PRIVATE ROAD	E-6
VILLA WEST	H-1-3
VILLA PARKWAY	E-6-7
STARBUCK DRIVE	D-6-7
WATERFORD	H-1-3
BACK BAY DRIVE	G-10-11
BLUE SPRINGS DRIVE	G-10
FLEETWOOD DRIVE	G-10-11
OPAL LANE	G-10
VILLAGE CENTER DRIVE	G-10-12
WILLOW BAY	I-3

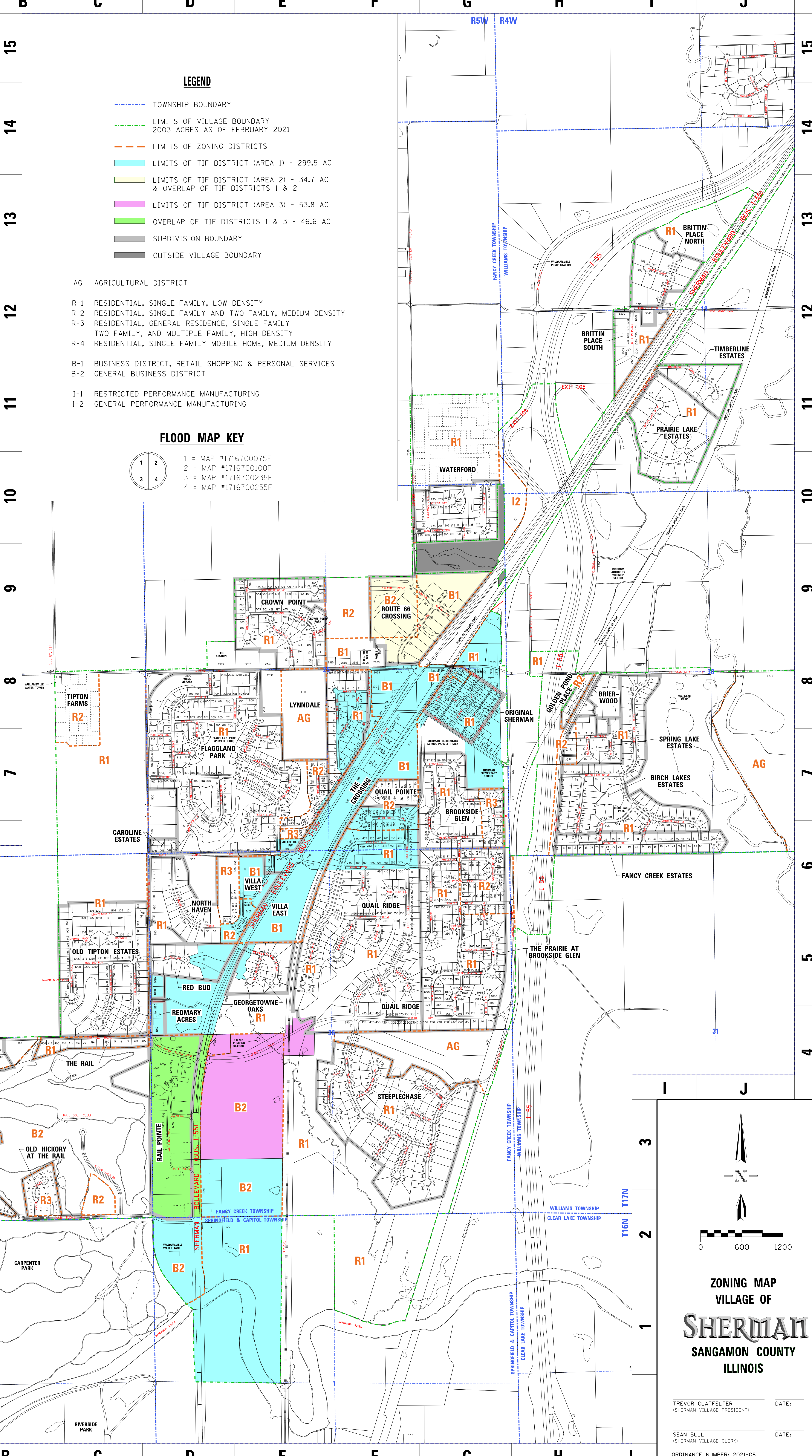

LEGEND

- TOWNSHIP BOUNDARY
- LIMITS OF VILLAGE BOUNDARY
2003 ACRES AS OF FEBRUARY 2021
- LIMITS OF ZONING DISTRICTS
- LIMITS OF TIF DISTRICT (AREA 1) - 299.5 AC
- LIMITS OF TIF DISTRICT (AREA 2) - 34.7 AC & OVERLAP OF TIF DISTRICTS 1 & 2
- LIMITS OF TIF DISTRICT (AREA 3) - 53.8 AC
- OVERLAP OF TIF DISTRICTS 1 & 3 - 46.6 AC
- SUBDIVISION BOUNDARY
- OUTSIDE VILLAGE BOUNDARY

AG AGRICULTURAL DISTRICT

R-1 RESIDENTIAL, SINGLE-FAMILY, LOW DENSITY
R-2 RESIDENTIAL, SINGLE-FAMILY AND TWO-FAMILY, MEDIUM DENSITY
R-3 RESIDENTIAL, GENERAL RESIDENCE, SINGLE FAMILY TWO FAMILY, AND MULTIPLE FAMILY, HIGH DENSITY
R-4 RESIDENTIAL, SINGLE FAMILY MOBILE HOME, MEDIUM DENSITY

B-1 BUSINESS DISTRICT, RETAIL SHOPPING & PERSONAL SERVICES
B-2 GENERAL BUSINESS DISTRICT

I-1 RESTRICTED PERFORMANCE MANUFACTURING
I-2 GENERAL PERFORMANCE MANUFACTURING

FLOOD MAP KEY

1	2
3	4

1 = MAP #17167C0075F
2 = MAP #17167C0100F
3 = MAP #17167C0235F
4 = MAP #17167C0255F

ZONING MAP
VILLAGE OF
SHERMAN
SANGAMON COUNTY
ILLINOIS

TREVOR CLATFELTER (SHERMAN VILLAGE PRESIDENT) DATE: _____
SEAN BULL (SHERMAN VILLAGE CLERK) DATE: _____

ORDINANCE NUMBER: 2021-08
EFFECTIVE DATE: MARCH 16, 2021